



Lifting Gear Hire Corporation

P: 800.878.7305 | F: 708-430-3536 | www.lgh-usa.com | sales@lgh-usa.com

50 - 1,000 Ton Single-Acting, Lock Nut Hydraulic Cylinder

ENERPAC CLL-Series

Optional Tilt Saddle available with Model CLL-40012

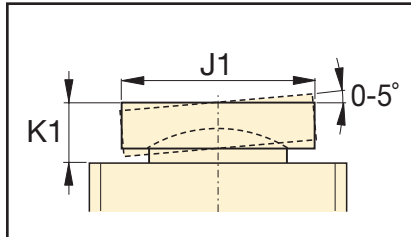

CLL Series



Specifications															
Cylinder Cap. Tons (Max)	Stroke (in)	Model	Cylinder Effective Area (in ²)	Oil Cap. (in ³)	Collapsed Height A (in)	Extended Height B (in)	Outside Dia. D (in)	Cylinder Bore Dia. E (in)	Plunger Dia. F (in)	Base to Adv. Port H (in)	Stand. Saddle Diam. J (in)	Saddle Protusion from Plgr. K (in)	Depth of Plunger Hole L (in)	Lock Nut Height S (in)	Weight (lbs)
50 (59.1)	1.97	CLL-502	10.99	21.63	6.46	8.43	4.92	3.74	Tr 95 x 4	1.18	2.80	.08	.51	1.42	35
	3.94	CLL-504	10.99	43.25	8.43	12.36	4.92	3.74	Tr 95 x 4	1.18	2.80	.08	.51	1.42	46
	5.91	CLL-506	10.99	64.88	10.39	16.30	4.92	3.74	Tr 95 x 4	1.18	2.80	.08	.51	1.42	57
	7.87	CLL-508	10.99	86.51	12.36	20.24	4.92	3.74	Tr 95 x 4	1.18	2.80	.08	.51	1.42	68
	9.84	CLL-5010	10.99	108.14	14.33	24.17	4.92	3.74	Tr 95 x 4	1.18	2.80	.08	.51	1.42	79
11.81	CLL-5012	10.99	129.76	16.30	28.11	4.92	3.74	Tr 95 x 4	1.18	2.80	.08	.51	1.42	90	
100 (102.9)	1.97	CLL-1502	20.57	40.50	7.36	9.33	6.50	5.12	Tr 130 x 6	1.18	2.80	.08	.51	1.73	68
	3.94	CLL-1004	20.57	81.00	9.33	13.27	6.50	5.12	Tr 130 x 6	1.18	2.80	.08	.51	1.73	87
	5.91	CLL-1006	20.57	121.50	11.30	17.20	6.50	5.12	Tr 130 x 6	1.18	2.80	.08	.51	1.73	106
	7.87	CLL-1008	20.57	162.00	13.27	21.14	6.50	5.12	Tr 130 x 6	1.18	2.80	.08	.51	1.73	125
	9.84	CLL-10010	20.57	202.50	15.24	25.08	6.50	5.12	Tr 130 x 6	1.18	2.80	.08	.51	1.73	143
11.81	CLL-10012	20.57	242.99	17.20	29.02	6.50	5.12	Tr 130 x 6	1.18	2.80	.08	.51	1.73	162	
150 (153.9)	1.97	CLL-1502	30.78	60.58	8.23	10.20	8.07	6.26	Tr 159 x 6	1.54	5.12	.08	.98	1.73	117
	3.94	CLL-1504	30.78	121.17	10.20	14.13	8.07	6.26	Tr 159 x 6	1.54	5.12	.08	.98	1.73	146
	5.91	CLL-1506	30.78	181.75	12.17	18.07	8.07	6.26	Tr 159 x 6	1.54	5.12	.08	.98	1.73	174
	7.87	CLL-1508	30.78	242.33	14.13	22.01	8.07	6.26	Tr 159 x 6	1.54	5.12	.08	.98	1.73	203
	9.84	CLL-15010	30.78	302.92	16.10	25.94	8.07	6.26	Tr 159 x 6	1.54	5.12	.08	.98	1.73	231
11.81	CLL-15012	30.78	363.50	18.07	29.88	8.07	6.26	Tr 159 x 6	1.54	5.12	.08	.98	1.73	260	
200 (206.1)	1.97	CLL-2002	41.17	81.04	9.57	11.54	9.25	7.24	Tr 184 x 6	1.97	5.12	.08	.98	1.97	183
	5.91	CLL-2006	41.17	243.13	13.50	19.41	9.25	7.24	Tr 184 x 6	1.97	5.12	.08	.98	1.97	260
	11.81	CLL-20012	41.17	486.27	19.41	31.22	9.25	7.24	Tr 184 x 6	1.97	5.12	.08	.98	1.97	376
250 (284.0)	1.97	CLL-2502	56.75	111.70	9.80	11.77	10.83	8.50	Tr 216 x 6	1.97	5.91	.08	.98	2.20	256
	5.91	CLL-2506	56.75	335.11	13.74	19.65	10.83	8.50	Tr 216 x 6	1.97	5.91	.08	.98	2.20	359
	11.81	CLL-25012	56.75	670.22	19.65	31.46	10.83	8.50	Tr 216 x 6	1.97	5.91	.08	.98	2.20	515
300 (353.6)	1.97	CLL-3002	70.71	139.19	11.61	13.58	12.20	9.49	Tr 241 x 6	2.32	5.47	.20	.98	2.36	382
	5.91	CLL-3006	70.71	417.56	15.55	21.46	12.20	9.49	Tr 241 x 6	2.32	5.47	.20	.98	2.36	514
	11.81	CLL-30012	70.71	835.11	21.46	33.27	12.20	9.49	Tr 241 x 6	2.32	5.47	.20	.98	2.36	712
400 (433.9)	1.97	CLL-4002	86.79	170.84	13.19	15.16	13.78	10.51	Tr 266 x 6	2.76	6.26	.20	.98	2.76	553
	5.91	CLL-4006	86.79	512.51	17.13	23.03	13.78	10.51	Tr 266 x 6	2.76	6.26	.20	.98	2.76	721
	11.81	CLL-40012	86.79	1,025.02	26.38*	34.84	13.78	10.51	Tr 266 x 6	2.76	6.26	.20	.98	2.76	972
500 (566.3)	1.97	CLL-5002	113.25	222.99	14.76	16.73	15.75	12.01	Tr 305 x 6	3.15	7.05	.20	.98	3.15	809
	5.91	CLL-5006	113.25	668.77	18.70	24.61	15.75	12.01	Tr 305 x 6	3.15	7.05	.20	.98	3.15	1,029
	11.81	CLL-50012	113.25	1337.55	24.61	36.42	15.75	12.01	Tr 305 x 6	3.15	7.05	.20	.98	3.15	1,360
600 (662.9)	1.97	CLL-6002	132.57	260.97	15.55	17.52	16.93	12.99	Tr 330 x 6	3.35	7.64	.20	.98	3.35	985
	5.91	CLL-6006	132.57	782.90	19.49	25.39	16.93	12.99	Tr 330 x 6	3.35	7.64	.20	.98	3.35	1,241
	11.81	CLL-60012	132.57	1,565.81	25.39	37.20	16.93	12.99	Tr 330 x 6	3.35	7.64	.20	.98	3.35	1,625
800 (911.6)	1.97	CLL-8002	182.42	359.09	17.91	19.88	19.88	15.24	Tr 387 x 6	3.94	8.82	.20	.98	3.94	1,565
	5.91	CLL-8006	182.42	1,077.27	21.85	27.76	19.88	15.24	Tr 387 x 6	3.94	8.82	.20	.98	3.94	1,918
	11.81	CLL-80012	182.42	2,154.55	27.76	39.57	19.88	15.24	Tr 387 x 6	3.94	8.82	.20	.98	3.94	2,446
1000 (1136)	1.97	CLL-10002	227.30	447.43	19.49	21.46	22.05	17.01	Tr 432 x 6	4.33	9.80	.20	.98	4.33	2,094
	5.91	CLL-10006	227.30	1,342.30	23.43	29.33	22.05	17.01	Tr 432 x 6	4.33	9.80	.20	.98	4.33	2,517
	11.81	CLL-100012	227.30	2,684.59	29.33	41.14	22.05	17.01	Tr 432 x 6	4.33	9.80	.20	.98	4.33	3,151

CLL-50 to CLL-250

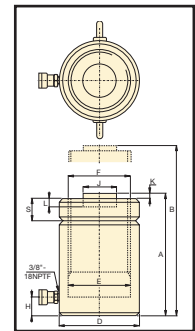

CLL-300 to CLL-1000

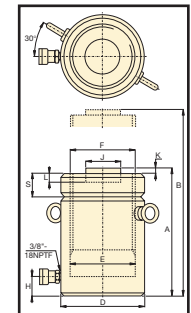

Green shading reflects rental inventory.

*Dimension shown includes optional tilt saddle