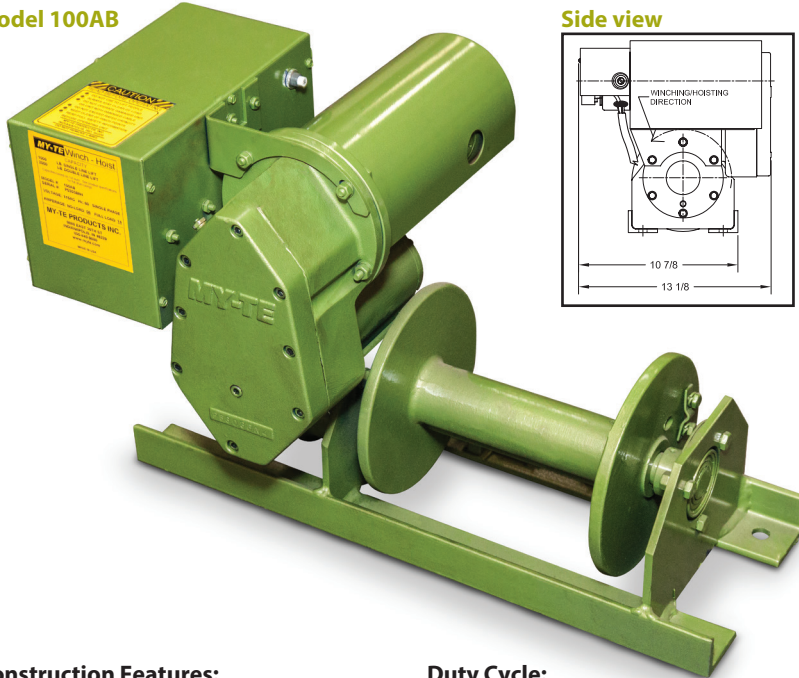
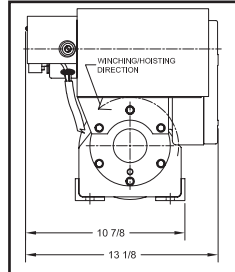
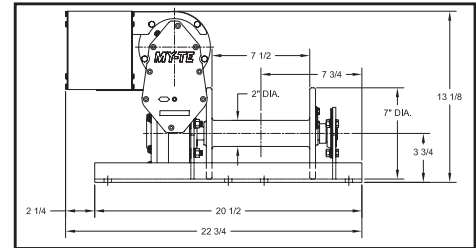
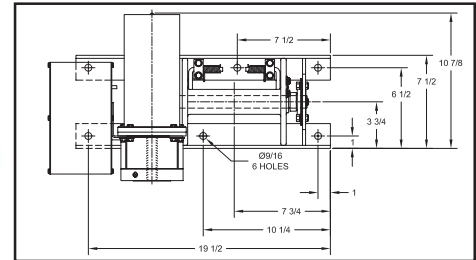

Electric Winches | 1,000 Lbs. | 100AB Model

Model 100AB

Side view

Front view

Top view

Construction Features:

- Heavy-duty angle base drilled for six (6) 1/2" bolts (9/16" mounting holes) with no welding required
- Fully sealed aluminum housings, with precision-cut gears, run in an oil bath
- Stress-proof drum shaft
- Frictionless bearings

Gear Systems:

- 286:1 total reduction
- Hardened steel worm and forged bronze worm gear holds load in position when stopped

Power:

- Universal 18,500 RPM reversible 1.25 HP motor (no-load speed)
- 15' power cord plugs into any 115 Volt, AC, grounded outlet
- 6 amp – No load
- 14 amp – Full load

Speeds:

- 59 RPM: No-load drum speed
- 30 FPM: No-load drum speed
- 25 FPM: 500 lbs. – single-line lift
- 20 FPM: 1,000 lbs. – single-line lift
- 10 FPM: 2,000 lbs. – double-line lift

Duty Cycle:

25% – 15 min/hr when operating at full load

Drum Storage:

- 1/4" – 250'
- 5/16" – 150'

Lifting Capacity:

- 1,000 lbs. – 1-2 layers of cable (39' of 1/4" cable)
- 850 lbs. – 3 layers of cable (65' of 1/4" cable)
- 600 lbs. – full drum of cable (250' of 1/4" cable)

Pulling Capacity:

- 10% (6°): 8,000 lbs. • 60% (31°): 1,500 lbs
- 20% (11°): 4,000 lbs. • 80% (39°): 1,300 lbs
- 40% (22°): 2,100 lbs. • 100% (45°): 1,100 lbs
- Level: 25,000 lbs.

My-te winch-hoists are rated for what they will vertically lift. The above data is based on the total load that may be pulled, single line, up a given incline. All capacities are reduced 20% to allow for minimum friction in pull.

Cable Strength:

- Safe working load is 20% of breaking strength
- Top-quality galvanized cable available in the following breaking strengths:
 - 1/4" – 6,800 lbs
 - 5/16" – 10,540 lbs

Shipping Weight:

- 76 lbs

Factory-Installed Options:

- 208 Volt
- Clutch
- Limit Switch
- Hand Crank
- Alternate Drums
- Upside-Down Mounting
- Variable Speed
- High Speed Gears

All My-Te winches are for **Material Handling Only!** They are not rated for lifting or transporting personnel.