

## Electric Winches | 3,000 Lbs. | AC36B Model

**Front view**

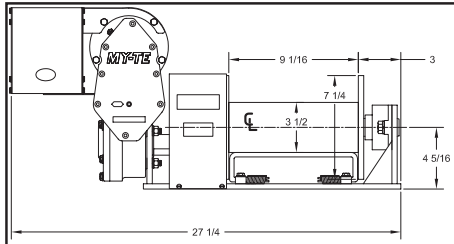

**Top view**

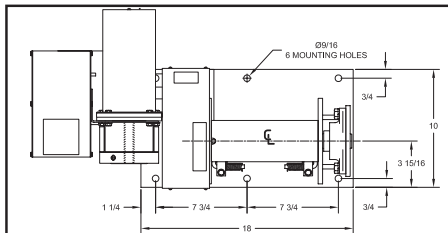

**Side view**

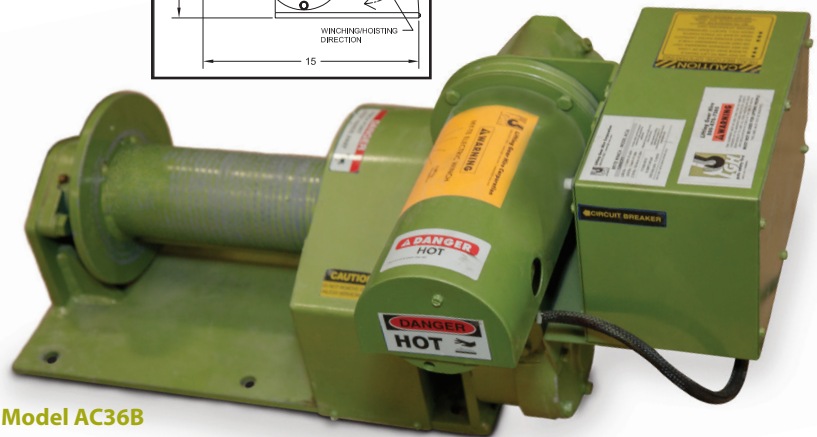
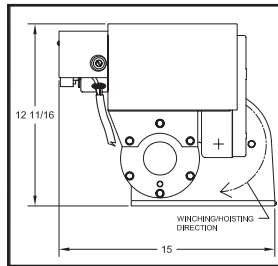

**Model AC36B**

### Construction Features:

- Heavy-duty angle base drilled for six (6) 1/2" bolts (9/16" mounting holes) with no welding required
- Fully sealed aluminum housings, with precision-cut gears, run in an oil bath
- Gear guard encloses external gear reduction
- Frictionless bearings

### Gear Systems:

- 1430:1 double reaction
- First reduction combines spur gears with hardened steel worm and forged bronze worm gear holds load in position when stopped
- Second reduction uses hardened heavy-duty spur gears

### Power:

- Universal 18,500 RPM reversible 1.25 HP motor (no-load speed)
- 15' power cord plugs into any 115 Volt, AC, grounded outlet
- 6 amp – No load
- 14 amp – Full load

### Speeds:

- 11 RPM: No-load drum speed
- 11 FPM: No-load drum speed
- 9 FPM: 1,000 lbs. – single-line lift
- 7.25 FPM: 3,000 lbs. – single-line lift
- 3.5 FPM: 6,000lbs. – double-line lift

### Duty Cycle:

- 25% – 15 min/hr when operating at full load

### Drum Storage:

- 1/4" – 250'
- 5/16" – 160'
- 3/8" – 110'

### Lifting Capacity:

- 3,000 lbs. – 1-2 layers of cable (37' of 3/8" cable)
- 2,650 lbs. – 3 layers of cable (64' of 3/8" cable)
- 2,150 lbs. – full drum of cable (110' of 3/8" cable)

### Pulling Capacity:

- 10% (6°): 24,000 lbs.
- 20% (11°): 12,200 lbs.
- 40% (22°): 6,400 lbs.
- 60% (31°): 4,600 lbs.
- 80% (39°): 3,800 lbs.
- 100% (45°): 3,300 lbs.
- Level: 75,000 lbs.

My-te winch-hoists are rated for what they will vertically lift. The data above is based on the total load that may be pulled, single line, up a given incline. All capacities are reduced 20% to allow for minimum friction in pull.

### Cable Strength:

- 5-1 recommended safety factor
- Top-quality galvanized cable available in the following breaking strengths:
  - 1/4" – 6,800 lbs
  - 5/16" – 10,540 lbs
  - 3/8" – 15,100 lbs

### Shipping Weight

- 132 lbs

### Factory-Installed Options:

- 208 Volt
- Clutch
- Upside-Down Mounting
- Model DC48 (12V DC Power)
- Divided Drum

For best results, use the minimum amount of cable required for application. Maintain four wraps of cable on the drum at all times. Cable sold separately. Length and size must be specified at time of order.

All My-Te winches are for **Material Handling Only!** They are not rated for lifting or transporting personnel.